

INSTALLATION AND SERVICE MANUAL

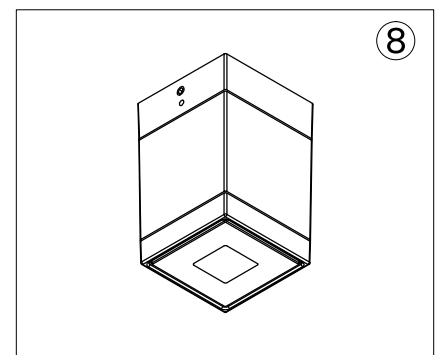

For Installation of Lador 9 ,10 surface downlight LED.
Model. ULD-80001 , ULD-80011

Product drawing (dimensions) SUITABLE FOR WET LOCATIONS

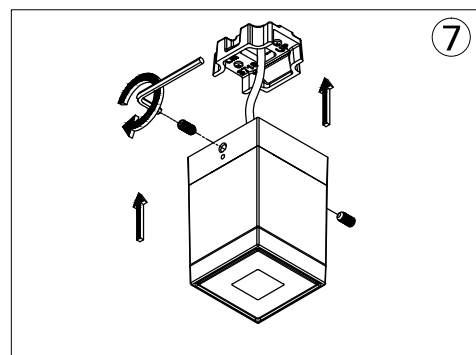
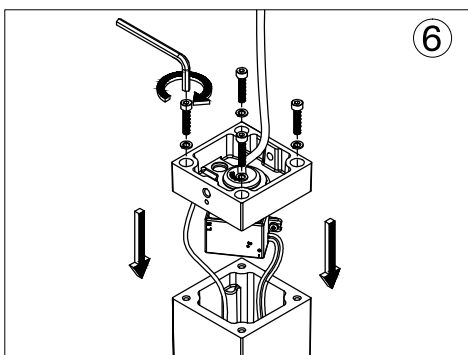
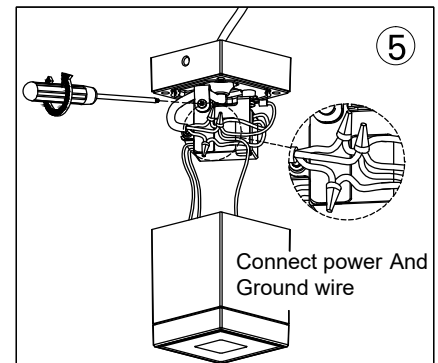
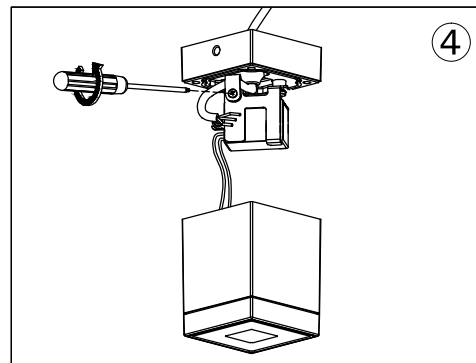
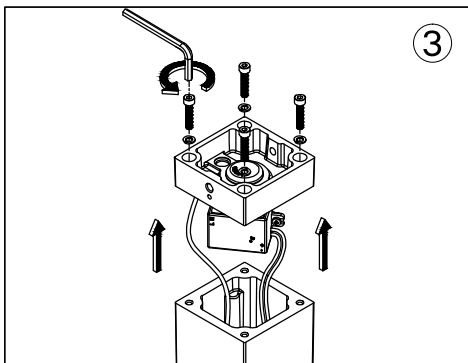
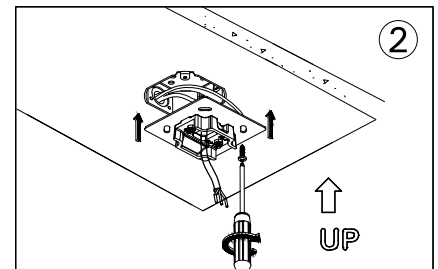
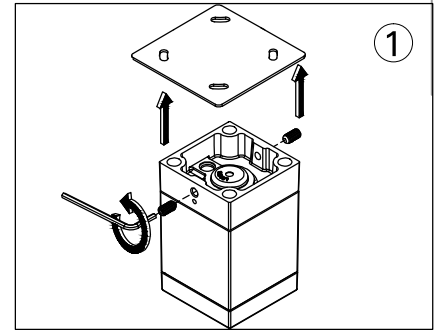
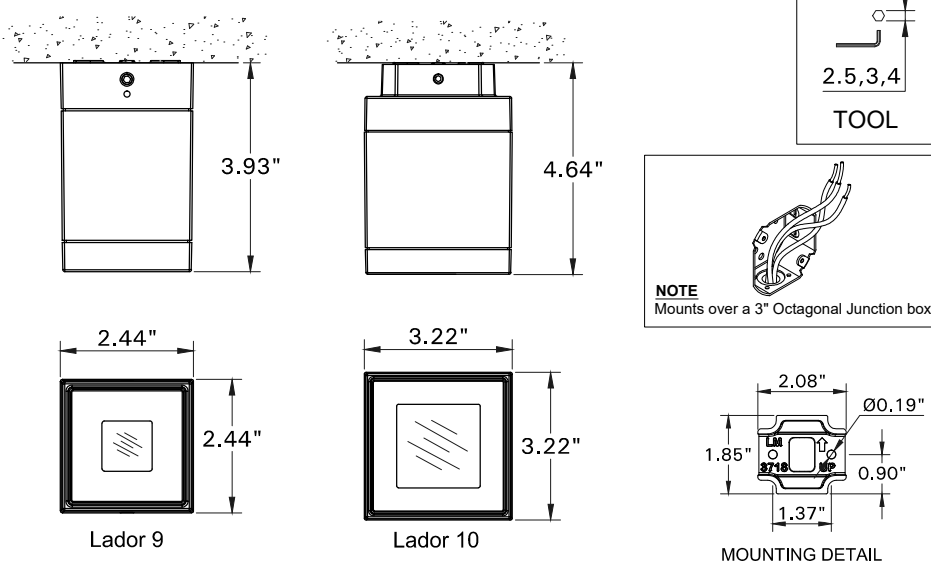

Notice to Installer

Wiring Instruction ⚠ Warning:

- Risk of Fire and Electrical Shock, This fixture must be installed only by a qualified electrician, Installation must adhere to the National Electrical Code (NEC) and all applicable local and federal regulations.
- Always disconnect power before servicing the fixture.

Ligman Lighting USA

7144 NE Progress Court, Hillsboro
Oregon, 97124, USA
Tel : 503 645 0500 | Fax : 503 645 8100

www.ligmanlightingusa.com